

6026-2RS1 Deep groove ball bearings

- Popular item
- SKF Explorer

Deep groove ball bearings

Bearing data

[Tolerances](#),

Normal (metric), P6, P5, Normal (inch),

[Radial internal clearance](#),

Matched bearing pairs, Stainless steel

d < 10 mm, Other bearings

Bearing interfaces

[Seat tolerances for standard conditions](#),

[Tolerances and resultant fits](#)

Technical specification

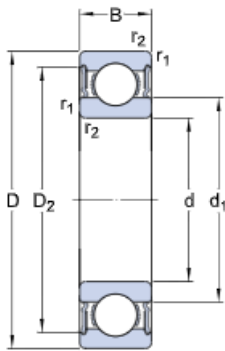

DIMENSIONS

d	130 mm	Bore diameter
D	200 mm	Outside diameter
B	33 mm	Width
d ₁	≈ 152.6 mm	Shoulder diameter
D ₂	≈ 181.4 mm	Recess diameter
r _{1,2}	min. 2 mm	Chamfer dimension

ABUTMENT DIMENSIONS

d _ε min.	139 mm	Diameter of shaft abutment
d _ε max.	152.9 mm	Diameter of shaft abutment
D _ε max.	191 mm	Diameter of housing abutment
r _a max.	2 mm	Radius of shaft or housing fillet

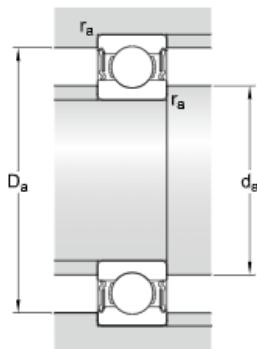

CALCULATION DATA

C	112 kN	Basic dynamic load rating
C ₀	100 kN	Basic static load rating
P _u	3.35 kN	Fatigue load limit
	2 000 r/min	Limiting speed
k _r	0.025	Minimum load factor
f ₀	15.8	Calculation factor

MASS

	3.32 kg	Mass bearing
--	---------	--------------

TOLERANCE CLASS

P6	Dimensional tolerances
Normal	Radial run-out